

MOBILE APP

WIFI AND MOBILE DATA

The ReachUC Mobile App is designed to utilize either your phone's mobile data or WiFi connection. Please follow the instructions below to set it to prefer either one.

HOW TO SELECT CONNECTION

1

With the App open and on the main keypad screen, click the gear (Settings) icon in the top right corner



2

From here, click "Preferences"

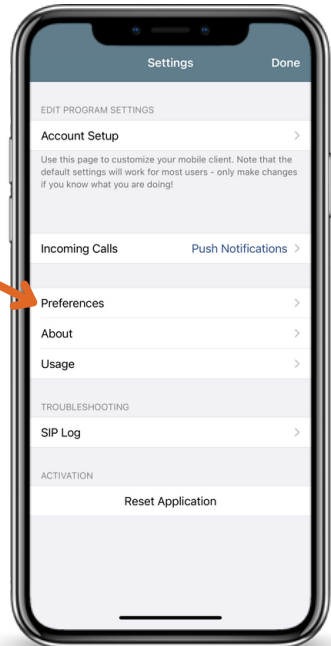

3

Next click "Network"

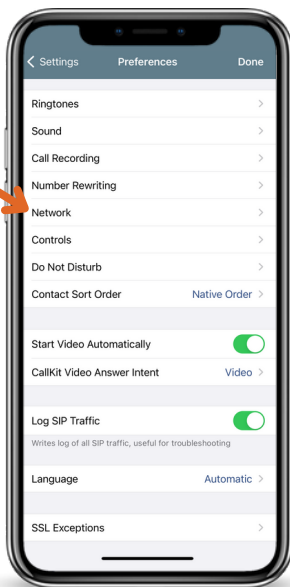

4

5

Select "Network Priorities for RTP"

Here you can choose between "Prefer Wi-Fi" or "Prefer Mobile Data"

